



MARIMBA

OWNER'S MANUAL

YM-2400 **YM-2400R**
YM-410

Thank you for selecting a Yamaha
musical instrument. We are confident that
the instrument will bring you years
of musical enjoyment and satisfaction.

Please read through this booklet carefully. It contains
important information about your instrument's care.
Your new Yamaha instrument, like all Yamaha musical
instruments, is the result of careful planning, testing
and assembly using select materials. Proper care
will ensure that your Yamaha instrument will deliver
its full and rich sound for years to come.

Contents

NOMENCLATURE	2
ASSEMBLY	3
HEIGHT ADJUSTMENT	6
PRECAUTIONS AND CARE	7
SPECIFICATIONS	8

NOMENCLATURE

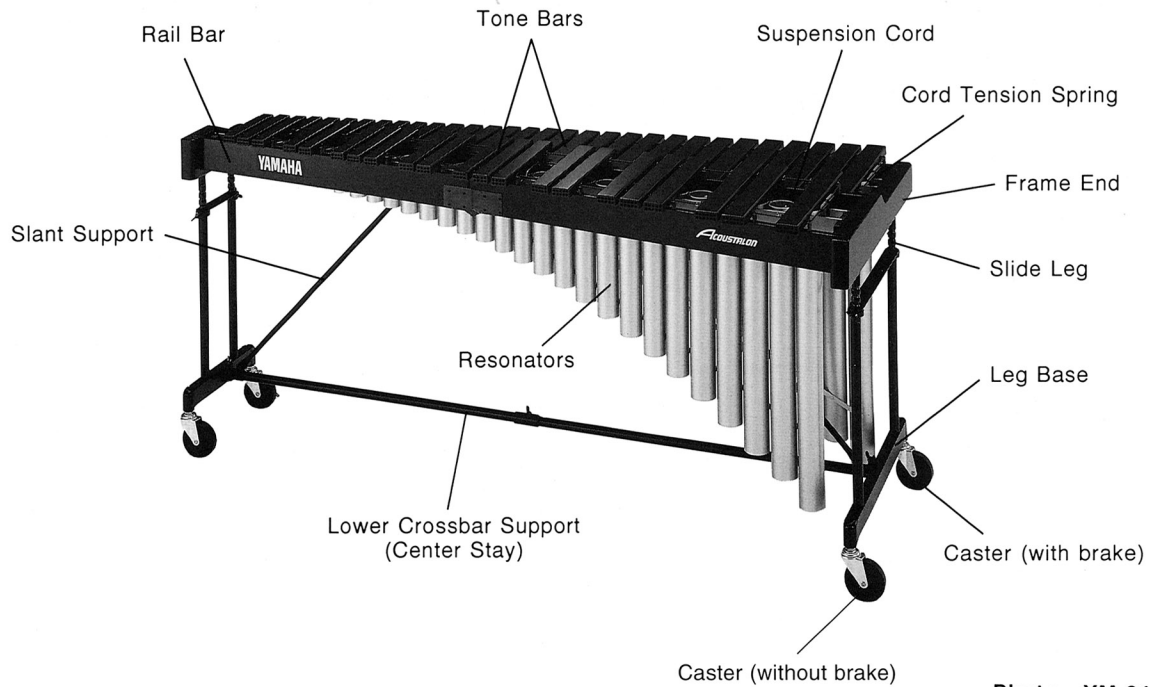
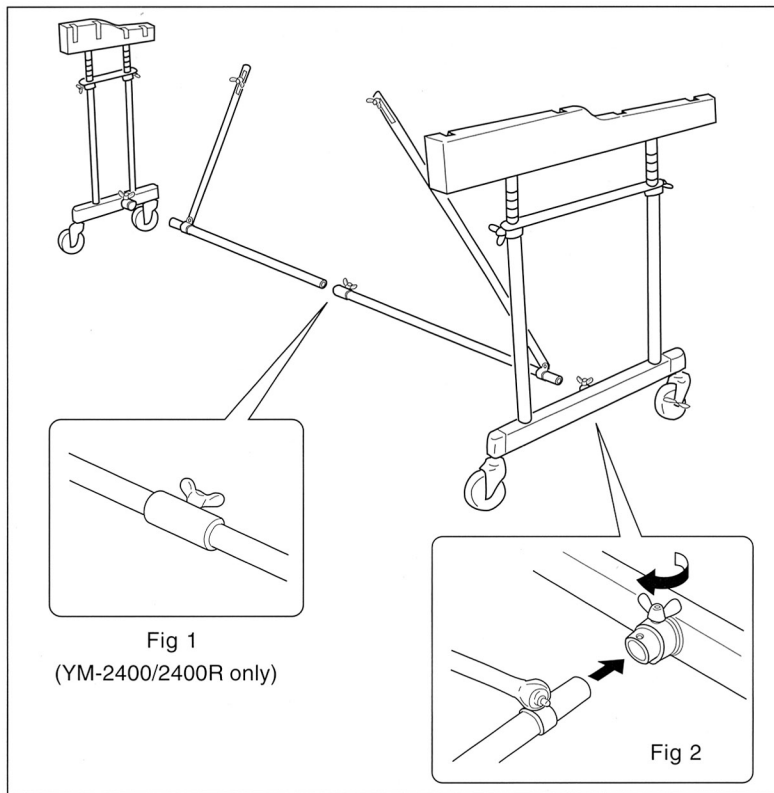
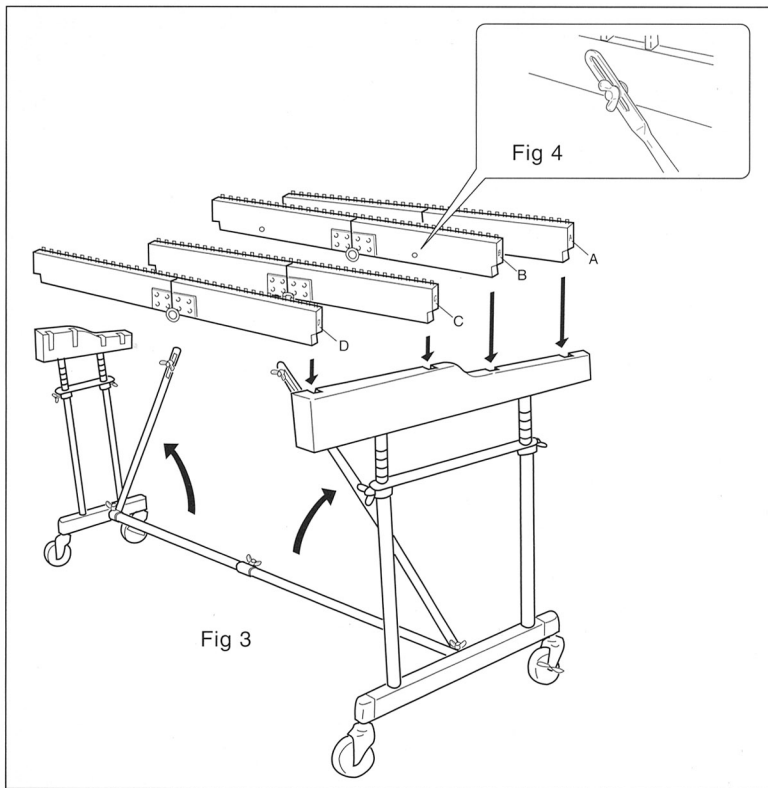

Photo : YM-2400



- 1 Assemble the lower crossbar supports by using the notch to assist alignment; then tighten the wing bolt. The wing bolt in the middle of the center stay should face the player. (YM-2400/2400R only) (Fig 1) Insert the lower crossbar support into the leg base by matching the letter E on the joint, then tighten the wing bolts. (Fig 2)



- 2 Unfold all rails. Attach the rails to the frame ends, matching the letter.
- 3 Connect the slant supports to the second rail from the player. (Fig 4)
If the height of the instrument has been raised, the slant supports will have to be adjusted. Make sure all wing bolts are securely fastened.

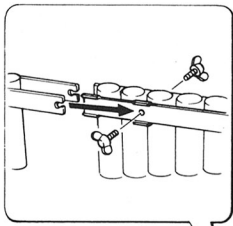

Fig 5

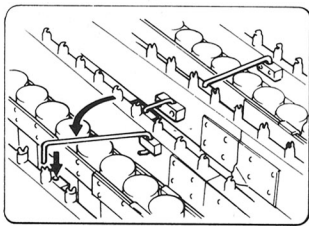

Fig 7

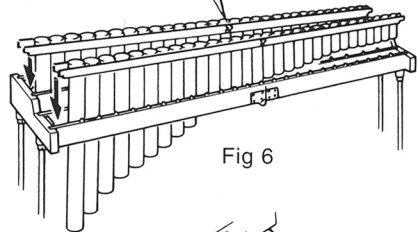

Fig 6

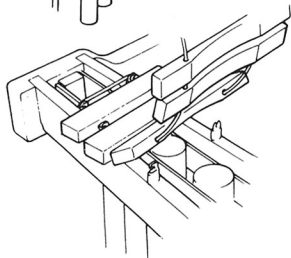

Fig 8

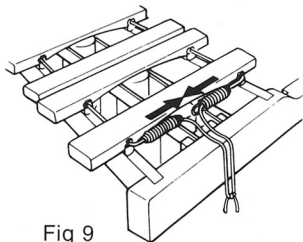
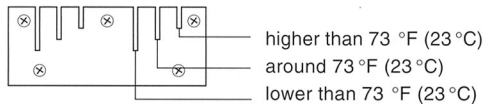

Fig 9

- 4 Assemble the resonators. (Fig 5) Lower the resonators over the frame into the resonator holders. (Fig 6) The rail clamps should be swung across the resonators and inserted into the blocks. (Fig 7)

NOTE

When placing the resonators in the resonator holder, place in the center groove if the room temperature is around 73 °F (23 °C). When the room temperature is higher to affect the resonance, use shallow slots: the deep slots when the temperature is lower.



- 5 Place the natural tone bars on the center of the rails and set each bar in position. Thread the suspension cord through each suspension post starting at the treble end. (Fig 8) Tighten the suspension cord and hook the spring. (Fig 9) Then set on the accidental bars. Wipe the top and sides of the instrument with a dry cloth. Check to see that all the nuts and bolts are tightened to prevent undesirable noise.

HEIGHT ADJUSTMENT

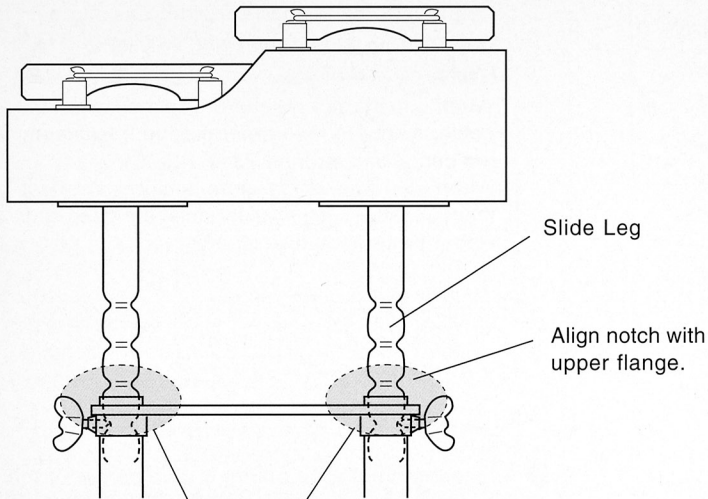

Do not touch the notched part during height adjustment to avoid injury.

* The fourth notch from top corresponds to the standard height setting.

This adjustment should always be performed by at least 2 persons.

To adjust the height of the tone bars, first remove the tone bars and resonators in the reverse order of steps, and loosen the slant support fixing bolts.

Loosen the slide leg fixing bolts on the high and low sound sides, while supporting the frame ends by hand.

Lift the frame ends to the desired height and then securely tighten each fixing bolt, aligning it with the corresponding notch of the slide leg. Bolt and notch are aligned when the next higher notch is flush with the upper leg flange.

Tighten the wing bolts on the slant supports.

NOTE

When a slide leg fixing bolt is tightened in between two notches, there is a danger of the slide leg slipping. Always make sure that the slide legs are held securely.

1. Do not use hard mallets or other hard materials to strike the tone bars. This could scratch, crack or dent them.
2. If the suspension cords are loose or unseated, resonance will be reduced. Check that the suspension cord is properly seated on each suspension post.
3. Avoid placing heavy objects on the tone bars as this may bend or twist the frame and loosen the suspension cords.
4. When transporting long distances, disassemble and pack carefully. Disassemble by reversing the assembly procedure.
5. Extremes in temperature and humidity will adversely affect the sound quality. Avoid high temperatures or humidity and do not store in direct sunlight.
6. Clean the instrument with a soft dry cloth. Do not use cloths dampened with chemical cleaning agents.

Assembly Cautions

- When assembling/disassembling the instrument, make sure to follow the procedure outlined in this manual. Assembly in the wrong order may impair the performance and functionality of the instrument or cause noise.
- After final adjustment of the legs the fixing screws must be tightened securely to prevent loosening. Looseness may cause the instrument to shift during performance and can also cause noise and other problems. Retighten the screws from time to time.

SPECIFICATIONS

Instrument	YM-2400	YM-2400R	YM-410
Scale Range	A ~ c ⁴ : 4-1/3 octaves	A ~ c ⁴ : 4-1/3 octaves	c ~ c ⁴ : 4 octaves
Tone Bar Material	Acoustalon™	Honduras Rosewood	Honduras Rosewood
Tone Bar Size (Width x Thickness)	58 ~ 38 x 23 mm (2-1/4" ~ 1-1/2" x 7/8")	58 ~ 38 mm x 25 ~ 21 mm (2-1/4" ~ 1-1/2" x 1" ~ 13/16")	58 ~ 38 mm x 25 ~ 21 mm (2-1/4" ~ 1-1/2" x 1" ~ 13/16")
Dimensions (Width x Depth x Height)	197 cm x 88 cm x 89~97 cm (77-1/2" x 34-5/8" x 35" ~ 38-1/4")	197 cm x 88 cm x 89~97 cm (77-1/2" x 34-5/8" x 35" ~ 38-1/4")	183 cm x 83 cm x 76~88 cm (72" x 32-11/16" x 30" ~ 34-5/8")
Weight	61 kg (134 lbs)	55 kg (121 lbs)	49 kg (108 lbs)
Pitch	A = 442 Hz	A = 442 Hz	A = 442 Hz

Specifications are subject to change without notice.

● SCALE RANGE



YM-2400/2400R

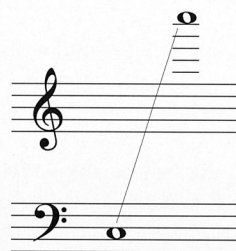

YM-410

